

**ARGYLL AND BUTE COUNCIL**  
 REFUSED by PLANNING AUTHORITY  
 Relative to Application No. 19/01801/PP  
 Head of Development and Economic Growth  
 Date: 13/01/2020

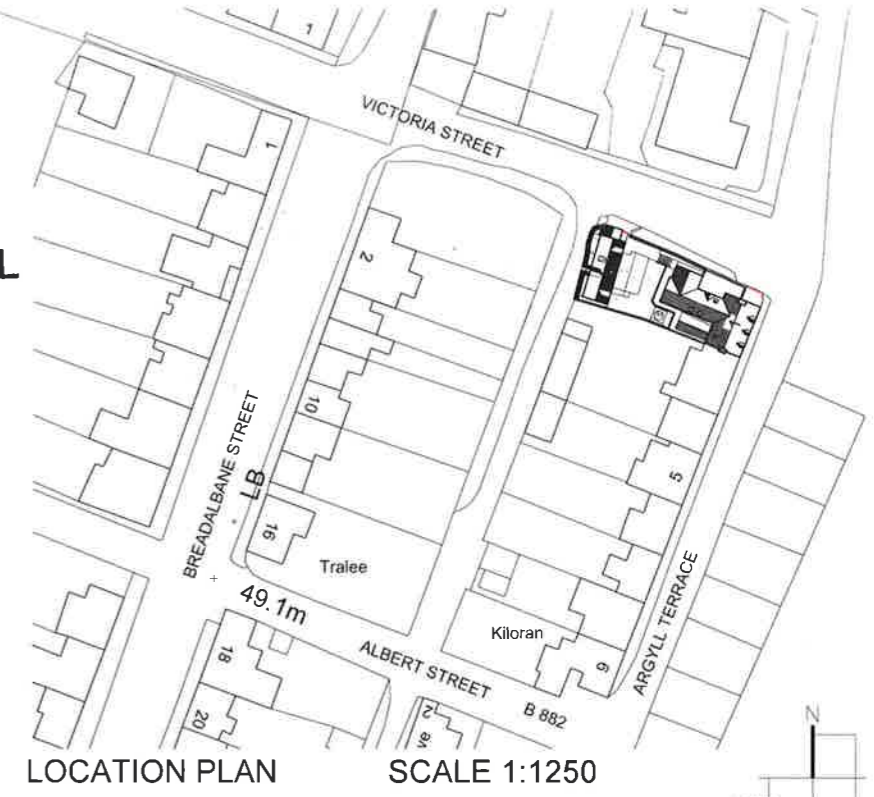

LOCATION PLAN SCALE 1:1250

Argyll and Bute Council  
 Planning and Regulatory Services

Application ref no: 19/01801/PP  
 Date received: 5/9/19  
 Plan no: 2 of 8  
 P.O. Initials: [initials]



BLOCK PLAN SCALE 1:100

AGL ARCHITECT  
 Architecture | Planning | Project Management  
 32 Carseview  
 Bannockburn  
 Stirling  
 FK7 8LQ  
 Tel: 01786 811533. Mob: 07814 139 222  
 E-mail: info@aglarchitect.co.uk Web: www.aglarchitect.co.uk

MR A. TOMKINSON  
 PROPOSED STAFF ACCOMMODATION  
 1 ARGYLL TERRACE, TOBERMORY  
 ISLE OF MULL

EXISTING SITE PLAN

|                   |          |       |          |
|-------------------|----------|-------|----------|
| scale             | date     | drawn | status   |
| 1:100, 1:1250 @A3 | 28.08.19 | JL    | PLANNING |
| proj no.          | Draw no. | REV   |          |
| 19-135            | 100      | A     |          |

A3